

# Town of Pelham User Fees and Charges 2023





---

## Overview

---

An experience at a summer camp or swim program,  
a requirement to obtain duplicate billing information or  
a new beginning obtaining a house permit,  
all of these experiences and more are realized within  
this guide.

---

User fees and charges are established to ensure that services specific to individuals are not subsidized by all ratepayers within the Town of Pelham

The Town of Pelham is proud to offer the experiences outlined in this guide at a minimal cost to the community members that require them.

The user fees and charges outlined in this document are regulated by By-law 4411 (2022).

### **Disclaimer**

Where it is found that a fee in this schedule is different than an approved bylaw or policy, the latter shall prevail.

All fees and charges do not include applicable taxes. Where fees and charges are subject to taxes, they will be added at point of sale.

### **Contact**

For more information about content found within this guide, please contact:



# Index



Clerk's Department

Corporate Services

Fire & By-Law Services

Planning & Development Services

Recreation & Cultural

Public Works





## Clerk's Department

**2023**

### Business Licensing

Itinerant Seller, Hawker, Peddler, Door to Door Seller	\$200.00
Refreshment Vehicle & Food Vending Vehicle	\$250.00
Bed and Breakfast, Fee <b>Per Bedroom</b>	\$150.00
Short Term Accommodation, Fee <b>Per Bedroom</b>	\$300.00

### Affidavits/Commissioner of Oath

Signature for all other documents – first document	\$15.00
Signature for all other documents – each additional document	\$5.00
Registrar statement/Travel letter – first letter	\$20.00
Registrar statement/Travel letter – each additional letter	\$5.00
Burial Permits/Death Registrations	\$10.00
Burial Permits/Death Registrations – After hours	\$100.00
Photocopies per page	\$0.25
Retrieval of Archived Records from Off-Site Storage	\$11.00

### Lottery Licensing

Bingo License % of prizes not exceeding \$5,500.00	3%
Raffle Lotteries % of prizes not exceeding \$50,000.00	3%
Bazaar Lotteries % of prizes not exceeding \$500.00	3%
Bazaar Lotteries – per wheel	\$10.00
Break Open Ticket (Nevada) Lottery % of prizes each occasion	3%
Break Open Ticket (Nevada) Lottery Home Base % of total	2.25%

<b>Line Fences Administrative Fee</b>	<b>\$425.00</b>
---------------------------------------	-----------------





## Clerk's Department

**2023**

### Marriage Licensing

License Fee	\$130.00
Ceremony Fee – On Site – Business Hours* - \$50 Deposit Required Upon Booking, non-refundable if cancelled by wedding couple	\$200.00
During COVID-19, Outdoor Weddings at Peace Park are preferred. Rental of Peace Park Bandshell applies (10 people) p/hr, OR:	\$14.00
*Rental Fee – Business Hours – MCC Accursi Lounge (25 people) p/hr	\$23.00
*Rental Fee – Business Hours – MCC ½ Accursi (50 people) p/hr	\$35.00 \$51.00
Ceremony Fee – Off Site and After Hours (Plus Expenses)	\$300.00
Rehearsal Fee	\$75.00
Witness Fee – Municipal Staff – Normal <b>Business</b> Hours – Each	\$25.00
Cleaning Fees, if required	\$100.00

### Municipal Property Damage – Billable

**Full Cost Recovery**

\*Note 1: For the duration of the COVID-19 Pandemic, Council Chambers is not available for civil marriage ceremonies. All indoor Weddings must be at MCC with limited attendance, subject to Provincial guidelines which may change from time to time. Minimal rental fees apply and are subject to HST.

### Freedom of Information

Application Fee	\$5.00
Photocopies – per page	\$0.20
Manual search, each 15 minutes	\$7.50
Preparation of record for disclosure – each 15 minutes	\$7.50
Retrieval of Archived Records in Off-Site Storage	\$12.50



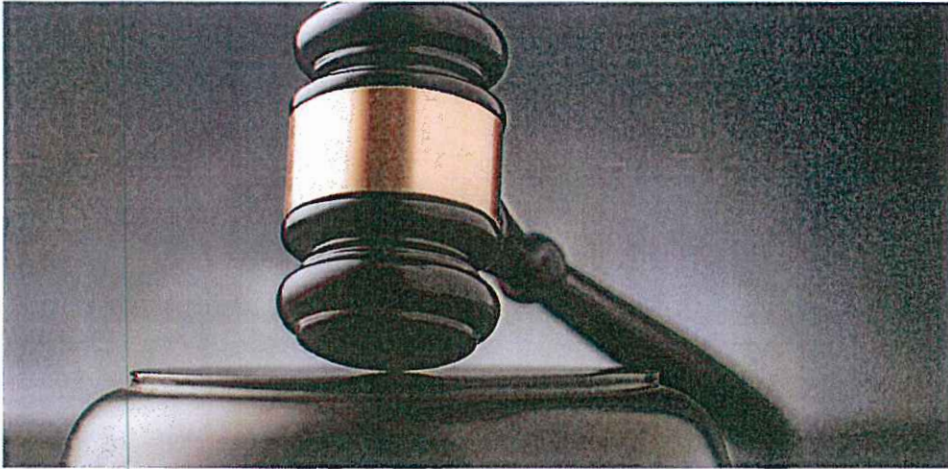

## Clerk's Department

**2023****Integrity Commissioner Complaint Filing Fee(s) \*Per Term of Council\***

First Complaint	No Fee
Second Complaint	\$100.00
Three or More Complaints	\$300.00

\*Please contact the Clerks Department for applicable exemptions





## Corporate Services

2023

### General Tax Services Fees

Statement of Tax Account	\$10.00
Reprint of Tax Bill	\$10.00
Tax Certificate – Mailed	\$50.00
Tax Certificate – Verbal	\$25.00
Interest and Penalty on Tax Arrears	1.25%
NSF Charge	\$30.00
New Roll Creation	\$40.00
Ownership Change	\$40.00
Mortgage Company Administration Fee	\$15.00

### Tax Registration Fees

Tax Registration	Actual fees charged plus 25%
After Final Notice	Actual fees charged plus 25%
Sale by Tender/Auction	\$2,200.00
Preparation of Extension Agreement	\$500.00
POA add to taxes	\$50.00

### General Accounts Receivable

Interest on Accounts Receivable	1.25%
NSF Charge on Accounts Receivable	\$30.00
Administrative Fee for Adding Arrears to Tax	\$25.00



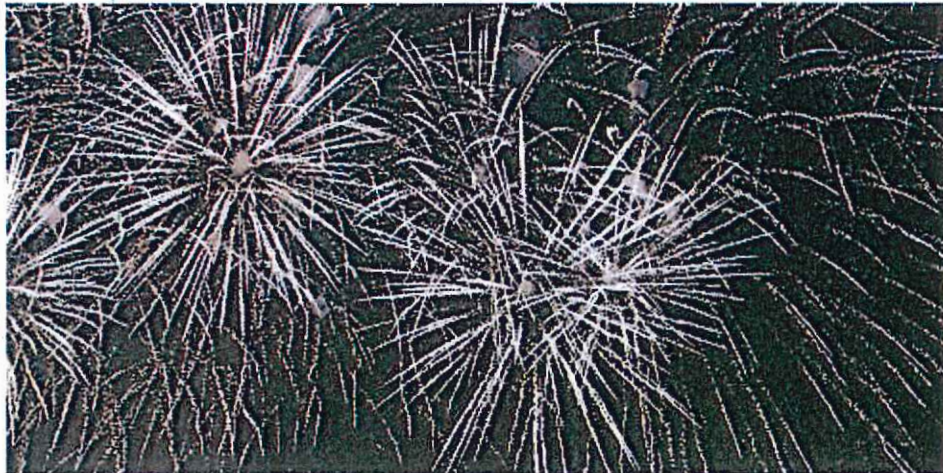

## Fire & By-Law Services

	2023
<b>Prevention, Protection and Inspection Fees</b>	
File Search	\$75.00
Request for Reports/Copies	\$75.00
Photographs	\$10.00
<b>Fireworks Permits</b>	
Sales	\$100.00
Storage	\$100.00
Display	\$100.00
<b>Fire Route Application</b>	
Administration Fee	\$100.00
<b>Residential Requests</b>	
Mortgage Clearance	\$100.00
Change of Ownership	\$100.00
Multi residential after two units (each)	\$25.00
Burn Permit (annual)	\$25.00
Burn Permit (new requiring an inspection)	\$50.00
<b>Commercial &amp; Industrial Requests</b>	
First 2000 square meters	\$200.00
Each additional 100 square meters (each)	\$50.00
Tenant Space Individual (each)	\$50.00





## Fire & By-Law Services

2023

### Prevention, Protection and Inspection Fees (continued)

#### L.L.B.O. Licenses Requests

Premises	\$100.00
Patio (each)	\$50.00
Special Occasions (each)	\$50.00

#### Hotels-Motels Requests

1-10 units	\$200.00
Over 10 units (per unit)	\$10.00

#### Day Care Requests

Day Nurseries/Home Day Care Licenses	\$150.00
--------------------------------------	----------

#### Fire Safety Plans

Approvals	\$50.00
-----------	---------

#### Inspection for Trade Shows

Home Shows/Special Functions	\$150.00
------------------------------	----------

Installation of Rural 911 Sign	\$100.00
--------------------------------	----------

#### Issuance of Occupant

Loads sign – 60 persons or less	\$50.00
Loads sign – 61 persons or more	\$100.00

Vacation Rental Inspection Fee	\$150.00
--------------------------------	----------





## Fire & By-Law Services

2023

### Prevention, Protection and Inspection Fees (continued)

#### Accreditation Inspections

Nursing Homes	\$150.00
Rest Homes	\$150.00
Seniors Apartments	\$150.00
Care Facilities	\$150.00

#### Fire Drills

Fire drill observation by (an) inspector(s) assigned by the chief fire official of any subsequent fire drill within the same calendar year	\$500.00
--	----------

#### Municipal Property Damage

Full Cost Recovery

#### Discretionary Fees

Equipment, Labour and/or Materials used at an incident	Full Cost Recovery
--	--------------------

#### False Alarm Response

Per hour per Fire Department Vehicle	\$510.00
Per additional ½ hour per Fire Department Vehicle	\$255.00

*Note: False Alarm Fees will only be implemented when it is determined by the Fire Chief that the false alarm was preventable or the fire alarm system was improperly installed, maintained or resulted from a malicious act by an individual. See By-Law 3085(2010) for details.*

#### Response to an unauthorized Open Air Burn

Per hour per Fire Department Vehicle	\$510.00
Per additional ½ hour per Fire Department Vehicle	\$255.00



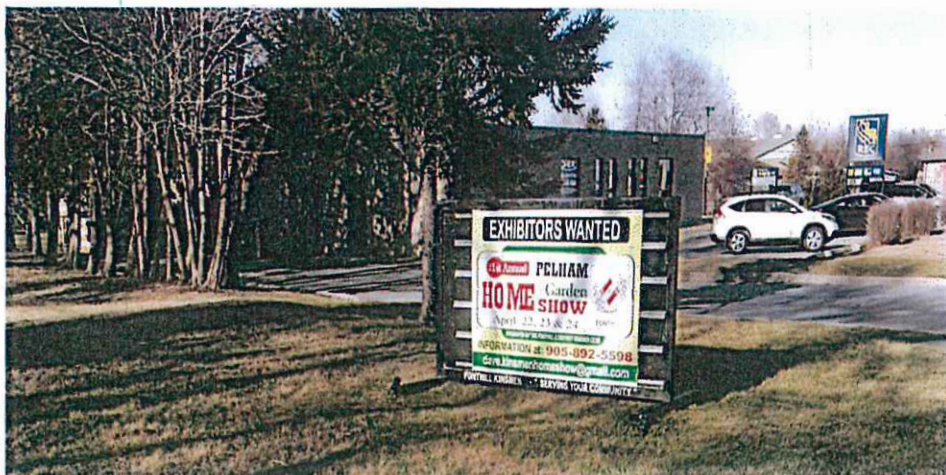

## Fire & By-Law Services

2023

### Municipal Property Damage (continued)

#### Motor Vehicle Fires and Collisions – Non Resident

Per hour per Fire Department Vehicle	\$510.00
Per additional ½ hour per Fire Department Vehicle	\$255.00

#### Fail to Comply with an Ontario Regulation causing an Emergency Response OR 210/01

Per hour per Fire Department Vehicle	\$510.00
Per additional ½ hour per Fire Department Vehicle	\$255.00

*Note: Motor Vehicle fires and Collisions – Non Resident MAY be charged where the Pelham Fire Department has responded to an emergency situation, including motor vehicle accidents and fire, in which a non-resident person is involved.*

### Sign Fees

Ground Signs up to 50 square feet	\$100.00
Ground Signs over 50 square feet	\$150.00
Portable Ground Signs (1-60 days)	\$100.00
Pole Signs	\$150.00
Roof Signs	\$150.00
Wall Signs	\$100.00
Temporary Special Event Signs	\$100.00
Projecting Signs	\$150.00

### Applications and Permits for Signs requiring Council Approval

Applications to Council for variance	\$250.00
--------------------------------------	----------





## Fire & By-Law Services

**2023**

### Property Standards & Clean Yard (default not remedied)

Administrative Fee	\$175.00
Initial Inspection Fee	\$95.00
Re-Inspection Fee	\$95.00
Mailing Fee	\$25.00

### Fencing

Application to Council for Fencing Variance	\$150.00
---	----------

Kennel License	\$100.00
----------------	----------





## Planning & Development Services

2023

### Planning Fees

Draft Plan of Subdivision	\$9,623.00
Resubmission of Draft Plan Prior to Approval	\$1,137.00
Modification to Draft Plan of Subdivision	\$6,014.00
Extension to Approval of a Draft Plan of Subdivision	\$963.00
Final Approval of a Draft Plan of Subdivision	\$1,806.00
Subdivision Agreement	*
Amendment to a Subdivision Agreement	\$904.00
Draft Plan of Condominium	\$4,813.00
Resubmission of Draft Plan of Condominium Prior to Approval	\$1,137.00
Modification to Approval of a Draft Plan of Condominium	\$2,407.00
Extension to Approval of a Draft Plan of Condominium	\$963.00
Town Consultant Review Fee	Full Cost Recovery
Condominium Agreement	*
Amendment to Condominium Agreement	\$904.00
Development Agreement Application	*or**
Town Consultant Review	Full Cost Recovery
Amendment to Development Agreement	\$904.00
Release of Development Agreement	\$1,085.00
Site Plan Approval Application **Note: separate fee for the agreement	\$4,210.00
Resubmission of Site Plan Prior to Approval	\$853.00
Site Plan Approval for Minor Development i.e. farm help house, triplex, building addition <100m <sup>2</sup> etc.	\$1,193.00
Town Consultant Review Fee	Full Cost Recovery





## Planning & Development Services

**2023**

Site Plan Amendment ***Note: Separate fee for the agreement	\$3,010.00
Release of Site Plan Agreement	\$1,085.00
*Subdivision Agreements, Site Plan Agreements and Development Agreements requiring the extension of municipal services	
Garden Suite Agreement	\$1,739.00
Encroachment Agreement	\$335.00
Zoning By-Law Amendment	\$4,813.00
APO Zoning By-Law Amendment	\$3,010.00
Official Plan Amendment	\$6,014.00
Combined Zoning By-Law & Official Plan Amendment	\$9,623.00
Extension of a Temporary Use By-Law	\$3,010.00
Removal of Holding Symbol	\$602.00
Town Consultant Review Fee	Full Cost Recovery
Repeal of Interim Control By-Law	\$1,202.00
Deeming By-Law	\$602.00
Lifting of Inhibiting Order	\$602.00
Lifting of One Foot Reserve	\$602.00
Removal of Part Lot Control	\$1,202.00
Communication Towers and Renewable Energy Application	\$1,202.00
Property Standards Appeal	\$602.00
Aggregate Application Fees	Full Cost Recovery
Real Estate Compliance Letter (10 business day service)	\$146.00
Real Estate Compliance Letter (Expedited 4 business day service)	\$234.00
Zoning Information Letter (10 business day service)	\$109.00



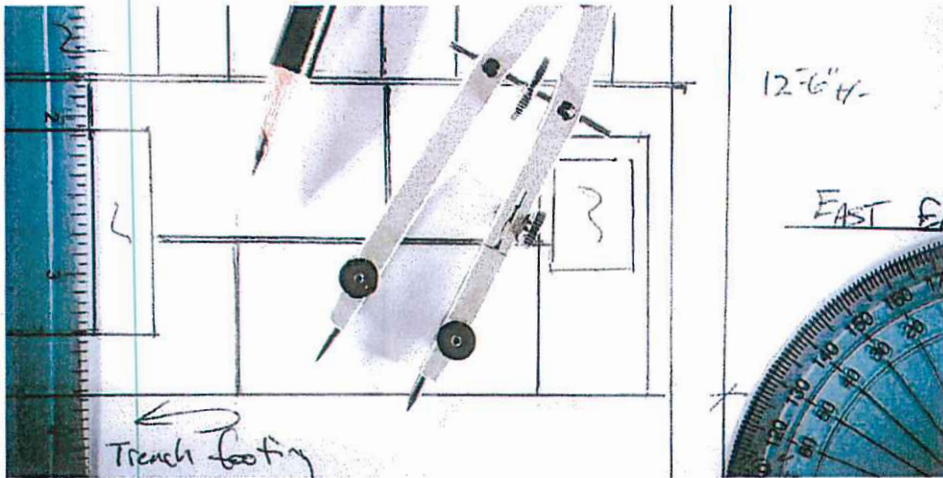

## Planning & Development Services

2023

### Planning Fees (continued)

- \* Subdivision Agreements, Site Plan Agreements and Development Agreements requiring the extension of municipal services

\$11,562.00 where the cost of construction of all Work is less than \$100,000.00;

\$11,562.00 plus 4.0% of the costs between \$100,000.00 and \$400,000.00;

\$25,113.00 plus three and one-half percent (3.5%) of the costs exceeding four hundred thousand dollars (\$400,000.00);

- \*\* Site Plan Agreements; and, Development Agreements where municipal services are not required to be extended \$2,893.00

- \*\*\* Shall be paid in addition to the Official Plan Amendment, Zoning By-Law Amendment and other planning application fees

Agreements for temporary Second Dwelling Units	\$1,114.00
Change of Address	\$128.00
Consent	\$1,607.00
Request for Change in Conditions	\$590.00
Rescheduling Fee	\$269.00
Final Certification	\$423.00
Recirculation Due to Change in Application	\$269.00
Special Hearing Fee (In Addition to Application Fee)	\$590.00
Minor Variance	\$1,178.00
Rescheduling Fee	\$269.00
Recirculation Due to Change in Application	\$269.00
Special Hearing Fee (In Addition to Application Fee)	\$590.00
Cancel Consent Application Fee	\$412.00
Cancel Consent Certificate Fee	\$103.00





## Planning & Development Services

	2023
<b>Building Permit Fees</b>	
Minimum Permit Fee unless otherwise stated	\$279.00
<b><i>New Construction – per square foot</i></b>	
<b>Assembly Occupancies – Group A</b>	
School, church, restaurant, theatre, educational or recreational facility and similar occupancies	\$1.92
Preparation of record for disclosure – each 15 minutes	\$8.06
<b>Institutional Occupancies – Group B</b>	
Hospital, nursing home, reformatory, prison and similar occupancies	\$1.92
<b>Residential Occupancies – Group C</b>	
Single Family Dwelling, Semi-Detached Dwelling & Duplex Dwelling	\$1.58
Multiple Unit Dwelling i.e. apartment dwelling, townhouse dwelling, hotels, motels, other residential buildings or parts thereof	\$1.62
Residential Additions	\$1.40
<b>Business/Personal Services Occupancies – Group D</b>	
Office, bank, medical office/clinic and similar occupancies	\$1.92
<b>Mercantile Occupancies – Group E</b>	
Store, Shopping mall/plaza, shop, market, retail outlet and similar occupancies	\$1.92
<b>Industrial Occupancies – Group F</b>	
Industrial mall, plaza, garage, plant, factory, warehouse, manufacturing building and similar occupancies	\$1.79
<b>Special Occupancies/Categories</b>	
New Farm Buildings	\$0.55
Tents	\$279.00





## Planning & Development Services

**2023**

### Special Occupancies/Categories per square foot (continued)

Park Model Trailer, Mobile Home	\$279.00
<b>Accessory Buildings/Structures</b>	
Garage/Carport, Deck/Porch/Patio, Sunroom/Solarium, shed or other accessory building	\$279.00 \$.094> 300/ft <sup>2</sup>
Private Swimming Pool	\$279.00
Public Swimming Pool or Spa	\$836.00
<b>Designated Buildings/Structures</b>	
Communication Tower, Solar Panels, Retaining Wall, Pedestrian Bridge, Wind Turbine, Crane Runway and similar buildings/structures	\$557.00
<b>Alterations &amp; Repairs – per square foot</b>	
<b>Interior Alterations/Repairs/Tenant Improvements</b>	
Assembly occupancies – Group A	\$0.44
Institutional Occupancies – Group B	\$0.44
Residential Occupancies – Group C	\$0.34
Business/Personal Service – Group D	\$0.44
Mercantile Occupancies – Group E	\$0.44
Industrial Occupancies – Group F	\$0.44
Alterations/Additions to existing Farm Buildings	\$0.30
Alter/Replace Roof Structure	\$0.44
Fireplace, Woodstove, Insert, Chimney and similar construction	\$279.00





## Planning & Development Services

**2023**

### *Demolition*

Part 9 Buildings/Structures	\$279.00
Other	\$836.00

### *Miscellaneous*

Partial Occupancy (does not apply to single family dwellings)	\$279.00
Change of use of a building or part thereof	\$279.00
Transfer of a Permit to a New Owner	\$279.00
Request for Deferral of Permit Revocation	\$279.00
Move a Building/Structure	\$279.00
Conditional Permit	\$668.00
Conditional Permit Agreement	\$279.00
Permit Renewal / Per Year	\$122.00
Re-inspection Fee	\$84.00
Clearance Letter	\$84.00
Building Code Order Compliance Letter	\$168.00
Hourly Rate	\$72.00
Occupant Load Inspection	\$279.00
Photocopying & printing per page	\$0.28
Alternative Solution Review	\$557.00

### *Partial Permit/Staged Construction*

Building Foundation	15%
Building Shell	75%
Building Completion	10%





## Planning & Development Services

2023

### Plumbing

For plumbing work not included in any of the above classes of permit

First 6 fixtures	\$279.00
Each additional	\$11.15

### Refund of Permit Fees

Where only administrative functions have been completed (application received and cost analysis complete)	90%
Where only administrative and zoning functions have been completed	80%
Where administrative, zoning and plans examination functions have been performed	60%
Where the permit has been issued and no inspections performed	50%
Deduction for each inspection performed	5%
No fees shall be refunded after twelve (12) months from the date of permit issuance or when refund is less than \$100	

### Construction Prior to Permit Issuance

Where construction has commenced prior to the issuance of a permit for any class of permit described herein, the permit fee shall be **doubled**

### Municipal Property Damage

Full Cost Recovery





## Recreation & Cultural Services

**2022**

### Arena Rentals

#### Ice Time – per hour (50min)

Prime Time - Weekdays 4pm – midnight & weekends	\$215.00
Prime Time - Youth	\$154.00
Non-Prime Time – Weekdays prior to 4pm	Youth \$91.00 / Adult \$118.00
Prime Time Last Minute Ice (less than 24hrs notice)	Youth \$75.00 / Adult \$118.00
Trainers Rate – 5 max	\$62.00

#### Summer Ice (April 15 – August 15)

Non-Prime Time	\$118.00
Prime Time - Youth	\$154.00
Prime Time - Adult	\$182.00

#### Corporate Sponsor Free Skate Rates

Prime Time Friday Skate Sponsorship per occurrence	\$270.00
Prime Time Sunday Skate Sponsorship per occurrence	\$315.00
Non-Prime Public Skate Sponsorship per occurrence	\$154.00

#### Public Skating

Adults	\$3.54
Students/Seniors	\$3.10
Child	\$3.10
Family (up to 5 members)	\$10.62
Preschool Skate	\$3.10
Non Profit Organized Group Rate	\$26.55

#### Children's Birthday Party (Under 14 yrs., Max 15 children)

• 2 hour hall + public skate or 1 hour gym	\$118.00
• + theme party (decorations)	N/A
• + specialty party (staff led options – tea party/craft/gym activities)	N/A





## Recreation & Cultural Services

### Arena Rentals (continued) 2023

Photo booth with props (no camera)	\$18.50
------------------------------------	---------

### Special Skating

Shinny Hockey Drop-In	\$5.31
-----------------------	--------

Women's Hockey – Learn To Play Drop-In	\$5.31
--	--------

Women's Hockey – Learn To Play Program + Shinny Combo	\$8.85
---	--------

Adult Learn To Skate (10 classes)	\$61.95
-----------------------------------	---------

Ticket Ice	\$5.31
------------	--------

### Summer Floor Rates – hourly

Hourly - Adult	\$56.00
----------------	---------

Hourly - Youth	\$37.00
----------------	---------

Daily Event	\$546.00
-------------	----------

Daily - Youth	\$357.00
---------------	----------

Event Electrical System Includes ESA inspection	\$1,150.00
---	------------

### MCC Arena Advertising

#### Accipiter Arena

On Ice (Per Ice Season/Year)	N/A
------------------------------	-----

Boards (Per Year)	\$1,000.00
-------------------	------------

#### Duliban Insurance Arena

On Ice (Per Ice Season/Year)	\$750.00
------------------------------	----------

Boards (Per Year)	\$800.00
-------------------	----------



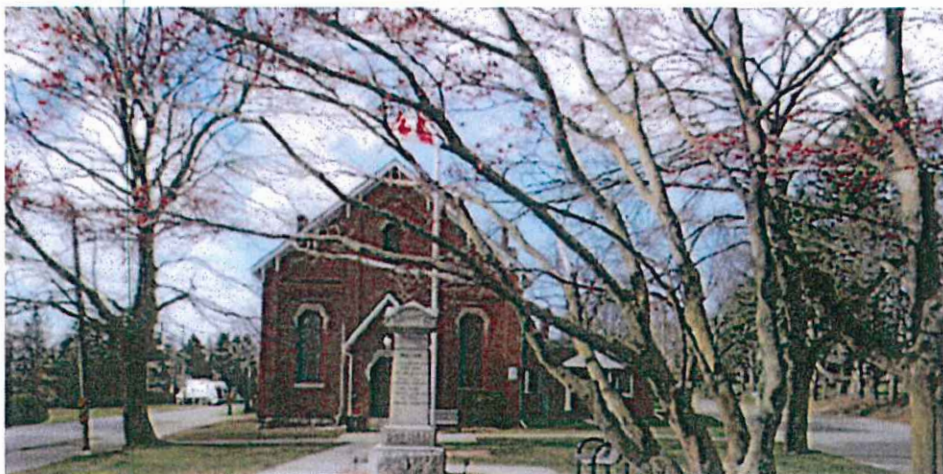

## Recreation & Cultural Services

<b>Rentals (continued)</b>		<b>2023</b>
Ice Resurfacer (Per Side/Year)		\$2,000.00
<b>Old Pelham Town Hall</b>		
Monday – Thursday (Daily Rental)		\$138.00
Monday – Thursday (Hourly Rental)		\$35.00
Friday – Sunday & Holidays (Daily Rental)		\$247.00
Friday – Sunday & Holidays (Hourly Rental)		\$51.00
Youth/Multiple Use Rate (5+) (Daily Rental Monday to Thursday)		\$110.00
West Lounge		\$37.00
Stage Rental per set up		\$225.00
Refundable Security Deposit (taxes not applicable)		\$100.00
SOCAN fee – without dancing per event		Full Cost Recovery
SOCAN fee – with dancing per event		Full Cost Recovery
<b>Meridian Community Centre Gymnasiums</b>		
½ gymnasium rental (hourly) Licensed Users-Youth Rate/Service Club		\$13.00
Full size gymnasium rental (hourly)		\$44.00
Full size gymnasium rental daily (Service Club)		\$260.00
½ gymnasium rental (hourly)		\$23.00
Custodial Charge (hourly)		\$39.00
Team Chairs (per event)		\$125.00
Set up & Use of Nets & Standards (Volleyball, Badminton, Pickleball)		\$10.00/per





## Recreation & Cultural Services

<b>Rentals (continued)</b>	<b>2023</b>
Equipment Rental (Volleyball; Badminton Racquet w shuttle; Pickleball Racket w ball)	\$2.00 per
Gym Floor Covering (Per Gym)	\$250.00/event

### **Meridian Community Centre – Kinsmen Community Room**

<b>FULL ROOM</b>	
Daily – Monday to Thursday	\$138.00
Hourly – Monday to Thursday	\$35.00
Daily – Friday to Sunday & Holidays	\$246.00
Hourly – Friday to Sunday & Holidays	\$51.00

<b>HALF ROOM</b>	
Daily – Monday to Thursday	\$68.00
Hourly – Monday to Thursday	\$19.00
Daily – Friday to Sunday & Holidays	\$123.00
Hourly – Friday to Sunday & Holidays	\$27.00

### **Meridian Community Centre – Dr. Gary & Mall Accursi**

#### **Multipurpose Community Room**

<b>FULL ROOM</b>	
Daily – Monday to Thursday	\$206.00
Hourly – Monday to Thursday	\$52.00
Daily – Friday to Sunday & Holidays	\$370.00
Hourly – Friday to Sunday & Holidays	\$76.00

<b>HALF ROOM</b>	
Daily – Monday to Thursday	\$137.00
Hourly – Monday to Thursday	\$35.00
Daily – Friday to Sunday & Holidays	\$246.00
Hourly – Friday to Sunday & Holidays	\$51.00





## Recreation & Cultural Services

<b>Rentals (continued)</b>		<b>2023</b>
<b>Special Functions Area</b>		
Hourly		\$23.00
Daily		\$87.00
Daily (with rental of Dr. Gary Accursi Multipurpose Community		\$54.00
<b>Community room – Kitchen</b>		
Daily (with rental of Dr. Gary & Mall Accursi Multipurpose Community Room)		\$54.00
<b>Atrium</b>		
TOP Facility User Groups – 8' space 1 table + 2 chairs/day per booth		\$26.00
<b>MCC Served – Ciolfi's Corner</b>		
Hourly		\$35.00
<b>MCC – Small Meeting Room (RCW Meeting Room &amp; Main Floor)</b>		
Monday to Thursday (Daily)		\$52.00
Friday to Sunday & Holidays (Daily)		\$83.00
Monday to Thursday (Hourly)		\$12.00
Friday to Sunday & Holidays (Hourly)		\$18.00
<b>Miscellaneous</b>		
Refundable Security Deposit (taxes not applicable)		\$100.00
Last Minute Cancellation Fee (less than 24hrs) – Applicable to all		\$41.00
SOCAN fee - without dancing per event		Full Cost Recovery
SOCAN fee – with dancing per event		Full Cost Recovery
Stage Rental per set up		\$125.00
Pelham Minor Hockey Association Courtyard (Hourly/Daily)		\$30.00/\$125.00
Portable Bar per rental		\$125.00





## Recreation & Cultural Services

<b>Rentals (continued)</b>		<b>2023</b>
Serving Fee per event		\$125.00
Linen Rental Fees		\$12.00/ item
Propane Heaters Rental Fee		\$30.00/heat
<b>Summer Field Rate Schedule</b>		
<b>Ball Diamonds</b>		
Level "A" groomed and lined		\$25.00
Level "A" youth		\$18.00
Level "C" no service		\$15.00
Level "C" youth		\$11.00
Diamond Lights (per hour)		\$13.00
<b>Tournaments &amp; Special Events</b>		
Level "A" groomed and lined		\$198.00
Level "A" youth		\$141.00
Level "C" no service		\$119.00
Level "C" youth		\$85.00
<i>Note: Fees do not include use of lights – apply per hour light fee if required</i>		
<b>Soccer Fields per hour</b>		
Adult		\$24.00
Minor		\$19.00
Soccer Lights (per hour)		\$31.00
<b>Soccer Tournament and Special Events</b>		
Adult		\$189.00
Minor		\$147.00
Soccer Field Lining – Non Municipal Fields per facility per lining		\$200.00





## Recreation & Cultural Services

**2023**

### Park Pavilions: Centennial Park & Harold Black Park and MSSP Park Pavillion

Park Pavilion	\$36.00
---------------	---------

### Passive Areas: Centennial Park & Harold Black Park

Permit Fee	\$31.00
------------	---------

### Peace Park including Bandshell

Pavilion Rate + Passive Area Rate (under 100 people)	\$69.00
Pavilion Rate + Passive Area Rate (over 100 people)	\$139.00
Per Hour Rate	\$16.00
SOCAN fee	Full Cost Recovery
Town Staff fee (per hour)	\$40.00
Hydro Fee for One Time Events	\$46.00

### Centennial Park Tennis and Pickle Ball Courts

Tennis lights per season	Full Cost Recovery
Family Membership	\$150.00
Single Adult Membership	\$100.00
Single Student/Senior Membership	\$50.00
Children (12 years and under)	Free
Outdoor Court Instructor Rental – per court per day up to 3 hrs per	\$20.00
Lesson Fees will be determined based on competitive rates	